

SAN ANTONIO HYATT REGENCY HOTEL

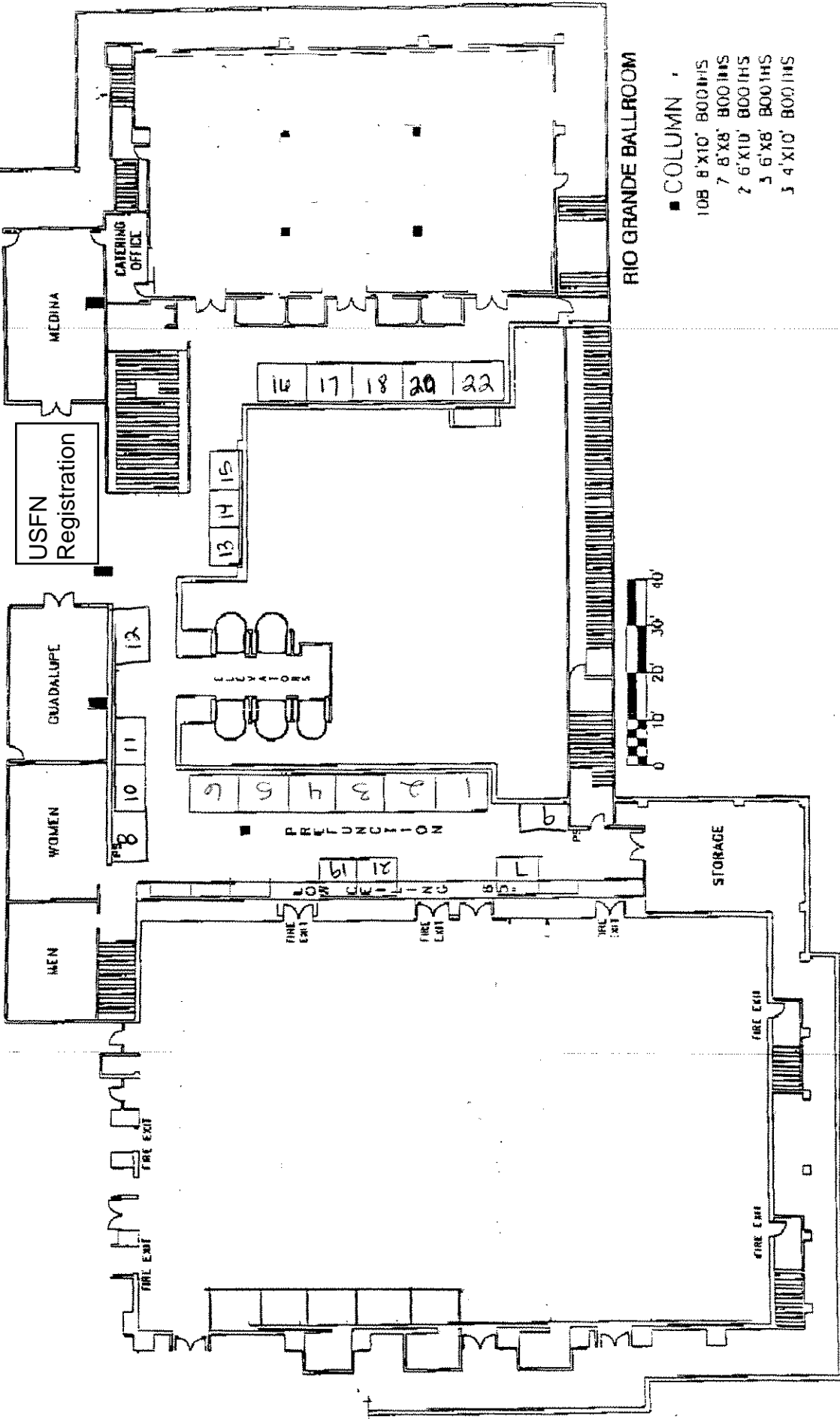

- COLUMN
- 10B 8'X10' 800IHS
- 7 8'X8' 800IHS
- 2 6'X10' 800IHS
- 3 6'X8' 800IHS
- 3 4'X10' 800IHS

DATE	02/00/00	BY	0000.DMC
PROJECT	HYATT REGENCY - San Antonio		
SCALE	1" = 10'-0"		
DRAWN BY	S. J. ...		
CHECKED BY	...		
DATE	02/00/00		
SCALE	1" = 10'-0"		

This plan was prepared in accordance with the requirements of the International Building Code, 1997 Edition, and the San Antonio Fire Department. It is intended for use as a guide only and does not constitute a contract. The user is responsible for verifying the accuracy of the information and for obtaining all necessary permits and approvals. The user is also responsible for obtaining all necessary insurance coverage. The user is further responsible for obtaining all necessary approvals from the appropriate authorities. The user is also responsible for obtaining all necessary approvals from the appropriate authorities.

**FREEMAN** Show Name  
 Companies Date  
 San Antonio, TX